

Dist	COUNTY	ROUTE	POST MILES TOTAL PROJECT	SHEET No.	TOTAL SHEETS

REGISTERED CIVIL ENGINEER DATE _____

PLANS APPROVAL DATE _____

THE STATE OF CALIFORNIA OR ITS OFFICERS OR AGENTS SHALL NOT BE RESPONSIBLE FOR THE ACCURACY OR COMPLETENESS OF SCANNED COPIES OF THIS PLAN SHEET.

NOTES:

1. FOR ACCURATE RIGHT OF WAY DATA, CONTACT RIGHT OF WAY ENGINEERING AT THE DISTRICT OFFICE.

STAGE 1 (WORK ON SOUTH SIDE)

TRAFFIC ON NORTH SIDE OF ROADWAY

LEGEND:

- ALTERNATIVE TEMPORARY CRASH CUSHION SYSTEM
- CHANNELIZER (SURFACE MOUNTED) 10' C-C
- PAVEMENT DELINEATION DETAIL NUMBER

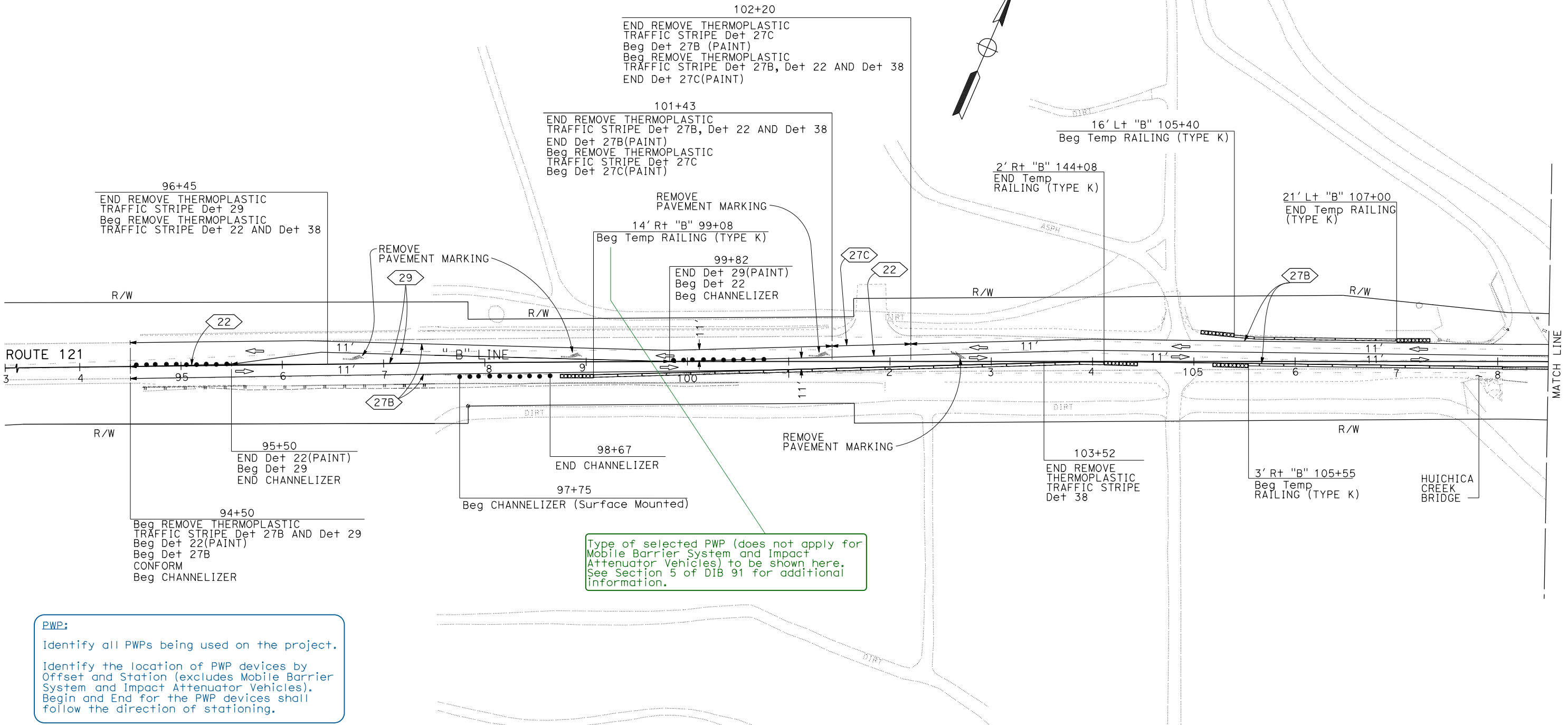
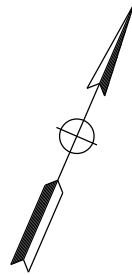

Type of selected PWP (does not apply for Mobile Barrier System and Impact Attenuator Vehicles) to be shown here. See Section 5 of DIB 91 for additional information.

PWP:

Identify all PWPs being used on the project.

Identify the location of PWP devices by Offset and Station (excludes Mobile Barrier System and Impact Attenuator Vehicles). Begin and End for the PWP devices shall follow the direction of stationing.

TRAFFIC HANDLING PLANS SHEET, EXAMPLE "121 TH-1"

TRAFFIC HANDLING PLAN

STAGE 1

SCALE: 1" = 50'

Subtitle/modifier goes underneath the sheet name. Use of parenthesis in not required to be used with subtitle.

APPROVED FOR TRAFFIC HANDLING WORK ONLY

STATE OF CALIFORNIA - DEPARTMENT OF TRANSPORTATION



TRAFFIC HANDLING SHEET RELEASED 11/05/2021

DATE PLOTTED => 28-OCT-2021
TIME PLOTTED => 15:05