

INDEX OF PLANS

STATE OF CALIFORNIA
 DEPARTMENT OF TRANSPORTATION
 PROJECT PLANS FOR CONSTRUCTION ON
STATE HIGHWAY
 IN SAN BERNARDINO COUNTY
 AT MOUNTAIN PASS
 FROM 0.3 MILE WEST
 OF CENDA DITCH BRIDGE
 TO WHEATON WASH BRIDGE

TO BE SUPPLEMENTED BY STANDARD PLANS DATED 2010

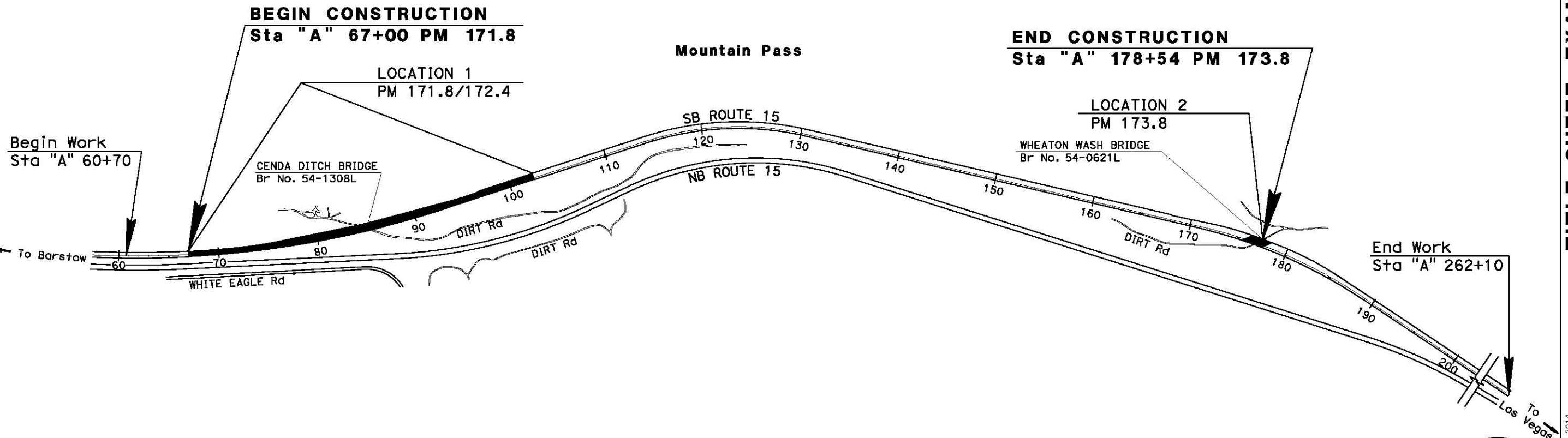

NO SCALE

TITLE SHEET, EXAMPLE "Y"
CONSTRUCTION ON ONE ROUTE AT TWO LOCATIONS
NEAR A NAME PLACE

PROJECT ENGINEER _____ DATE _____
 REGISTERED CIVIL ENGINEER



PLANS APPROVAL DATE _____

THE STATE OF CALIFORNIA OR ITS OFFICERS OR AGENTS SHALL NOT BE RESPONSIBLE FOR THE ACCURACY OR COMPLETENESS OF SCANNED COPIES OF THIS PLAN SHEET.

CONTRACT No.	
PROJECT ID	

THE CONTRACTOR SHALL POSSESS THE CLASS (OR CLASSES) OF LICENSE AS SPECIFIED IN THE "NOTICE TO BIDDERS."